

BREAKBACK

折彎式扭力扳手 Window Torque Wrench

- Push-through ratchet allows two direction tightening.
- Tolerance of torque $\pm 4\%$.
- Quality meets DIN ISO 6789 & ASME B107.300-2010.

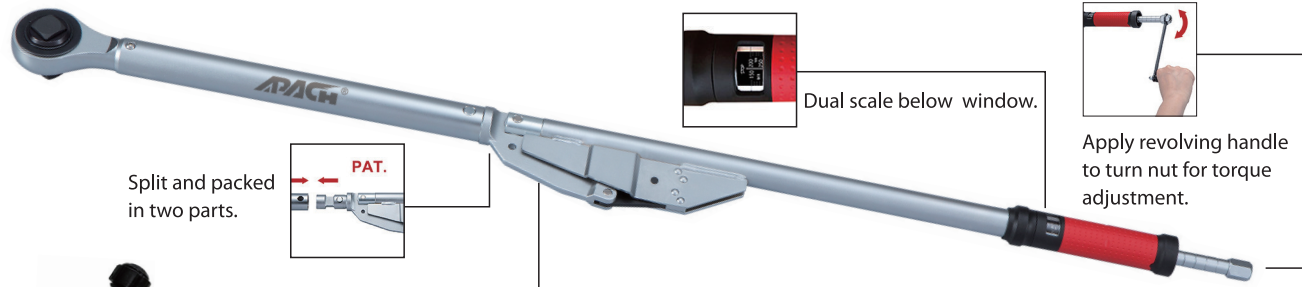

Renewal Kit

Split and packed in two parts.

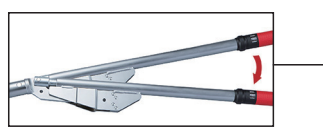
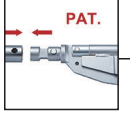

Press down smoothly on the handle in direction in dicated by arrow.

Item Number	Square Drive	Teeth	Nm/ft-lb	Graduation	g	L(mm)	case /CTN
ATW0601-34	3/4"	36T	120-600/100-450	10	6600	1060	2
ATW0602-34	3/4"	36T	200-800/150-600	10	7900	1320	1
ATW0603-34	3/4"	36T	300-100/200-750	20	8060	1550	1
ATW0604-10	1"	36T	120-600/100-450	10	6600	1060	2
ATW0605-10	1"	36T	200-800/150-600	10	7900	1320	1
ATW0606-10	1"	36T	300-1000/200-750	20	8060	1550	1

NUMERIC

視窗型扭力扳手 Window Torque Wrench

- Tolerance of torque $\pm 3\%$.
- CW/CCW direction.
- Quality meets DIN ISO 6789 & ASME B107.300-2010.

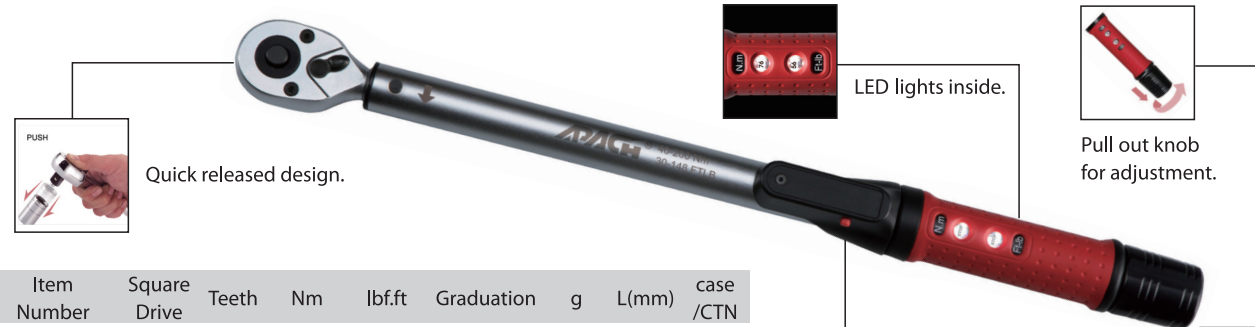

Quick released design.



LED lights inside.



Pull out knob for adjustment.

Item Number	Square Drive	Teeth	Nm	lbf.ft	Graduation	g	L(mm)	case /CTN
ATW0001-14	1/4"	24T	4-20	3-14.8	0.1	800	368	24
ATW0002-38	3/8"	24T	4-20	3-14.8	0.1	800	368	24
ATW0003-38	3/8"	32T	20-100	15-74	0.5	1200	435	12
ATW0004-12	1/2"	32T	40-200	30-148	1	1470	510	12
ATW0005-12	1/2"	32T	60-340	44-251	2	1670	615	12



Red push button for LED light; click once again to close. 12V battery is required.

SPLIT-BEAM

彈力式扭力扳手 Window Torque Wrench

- Torque of tolerance: unflexed $\pm 4\%$; flexed $\pm 4\sim \pm 10\%$.
- Non coil-spring mechanism and no need to return to zero after use, which brings longer tool life.



Renewal Kit

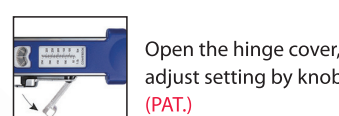

Open the hinge cover, adjust setting by knob (PAT.)



Setting display in window

Item Number	Square Drive	Teeth	Swing arc	Nm/ft-lb	Graduation	g	L(mm)	case /CTN
ATW1101-38	3/8"	32T	15	25-130	-	-	-	-
ATW1102-12	1/2"	32T	15	70-350	5	1705	590	12
ATW1103-38	3/8"	32T	15	20-100	-	-	-	-
ATW1104-12	1/2"	32T	15	40-250	5	1705	590	12

ROBUST

G型視窗型扭力扳手 Window Torque Wrench

- Adjustable torque wrench with square drive for controlled tightening
- Tolerance of torque $\pm 4\%$.
- Quality meets DIN ISO 6789 & ASME B107.300-2010.



Reliable mechanism: Loud click sound and strong impulse when required torque is reached.

Dual scale below window.

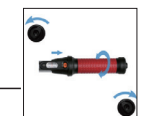

- Turn to left.
- Adjust the torque.
- Turn to right and lock.

Item Number	Square Drive	Teeth	Nm	lbf.ft	Graduation	g	L(mm)	case /CTN
ATW0501-14	1/4"	24T	5-25	3.6-18	0.1	410	296	24
ATW0502-38	3/8"	24T	10-50	7.4-37	0.25	470	333	12
ATW0503-12	1/2"	32T	20-100	15-75	0.5	820	400	12
ATW0504-12	1/2"	32T	40-200	30-150	1	1300	500	12
ATW0505-12	1/2"	32T	60-300	45-220	1	1470	635	12
ATW0506-34	3/4"	24T	100-600	75-440	2	4560	1040	2
ATW0507-34	3/4"	24T	150-800	110-590	5	5192	1161	2
ATW0508-34	3/4"	24T	200-1000	150-740	5	5192	1161	2



Renewal Kit

SLIPPING

空轉式扭力扳手 Window Torque Wrench

- Unique continuous slipping mechanism eliminates the risk of over tightening.
- Tolerance of torque $\pm 6\%$. (1-5NM, 2-10NM)
- Tolerance of torque $\pm 4\%$. (5-25NM, 10-60NM, 20-100NM)
- Quality meets DIN ISO 6789 & ASME B107.300-2010.

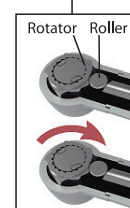

Slipping Mechanism: When the torque value is achieved, the mechanism slips through over the roller and automatic resetting.

Dual scale below window.

- Turn to left.
- Adjust the torque.
- Turn to right and lock.

Item Number	Square Drive	Teeth	Nm	lbf.ft	Graduation	g	L(mm)	case /CTN
ATW0201-14	1/4"	36T	1-5	0.7-3.7	0.05	520	260	24
ATW0202-14	1/4"	36T	2-10	1.5-7.4	0.1	520	260	24
ATW0203-14	1/4"	36T	5-25	3.5-18	0.1	590	320	24
ATW0204-38	3/8"	36T	5-25	3.5-18	0.1	590	320	24
ATW0205-38	3/8"	48T	10-60	8-44	0.25	655	355	24
ATW0206-38	3/8"	-	6-100	18-75	-	-	-	-
ATW0207-12	1/2"	48T	10-60	8-44	0.25	655	355	24
ATW0208-12	1/2"	-	7-100	18-75	-	-	-	-
ATW0209-14	1/4"	36T	2-10	20-90 (in-lb)	0.1	520	260	24



Renewal Kit

AO080ACP
AW050H
New Air
Impact Wrench
Air Impact
Wrench
Air
Screwdriver
Air Ratchet
Wrench
Air
Die Grinder
Air
Grinder Series
Air Sander
Air Spray Gun
Air Blow Gun
Air Reverser
Nut Tool
Window Torque
Wrench Series
Patented
Hand Tool Set